

Hardened & Ground Helical Racks Material

Helical Cut

19° 31' 42" H.A. RH.
20° P.A.

C45E DIN 1.1191



Profile: All faces ground
Quality: 6h23 DIN 3962/63/67

Adjacent pitch error (mm):

Mod ≤ 3: 0.006

Mod > 3: 0.008

Tolerance of cut for continuous mounting
-0.05 / -0.2 (mm)

Helical Racks Helical Cut

PART NUMBER	Normal Pitch	P_t	Mod	L	L_1	Teeth	b	h	h_o	$f+0.5$	a
HPC246012	4.712	5.00	1.5	500.00	6.7	100	19	19	17.50	2	62.5
HPC246013	4.712	5.00	1.5	1000.00	6.7	200	19	19	17.50	2	62.5
HPC246022	6.283	6.67	2.0	500.00	8.5	75	24	24	22.00	2	62.5
HPC246023	6.283	6.67	2.0	1000.00	8.5	150	24	24	22.00	2	62.5
HPC246032	7.854	8.33	2.5	500.00	8.5	60	24	24	21.50	2	62.5
HPC246033	7.854	8.33	2.5	1000.00	8.5	120	24	24	21.50	2	62.5
HPC246042	9.425	10.00	3.0	500.00	10.3	50	29	29	26.00	2	62.5
HPC246043	9.425	10.00	3.0	1000.00	10.3	100	29	29	26.00	2	62.5
HPC246052	12.566	13.33	4.0	506.67	13.8	38	39	39	35.00	3	62.5
HPC246053	12.566	13.33	4.0	1000.00	13.8	75	39	39	35.00	3	62.5
HPC246062	15.708	16.67	5.0	500.00	17.4	30	49	39	34.00	3	62.5
HPC246063	15.708	16.67	5.0	1000.00	17.4	60	49	39	34.00	3	62.5
HPC246072	18.850	20.00	6.0	500.00	20.9	25	59	49	43.00	3	62.5
HPC246073	18.850	20.00	6.0	1000.00	20.9	50	59	49	43.00	3	62.5
HPC246082	25.133	26.66	8.0	480.00	28.0	18	79	79	71.00	3	60.0
HPC246083	25.133	26.66	8.0	960.00	28.0	36	79	79	71.00	3	60.0
HPC246092	31.416	33.33	10.0	500.00	35.1	15	99	99	89.00	3	62.5
HPC246093	31.416	33.33	10.0	1000.00	35.1	30	99	99	89.00	3	62.5

p_t (mm) : Transverse Pitch

Material **Hardened & Ground Helical Racks**

C45E DIN 1.1191

19° 31' 42" H.A. RH.
20° P.A.

Helical Cut

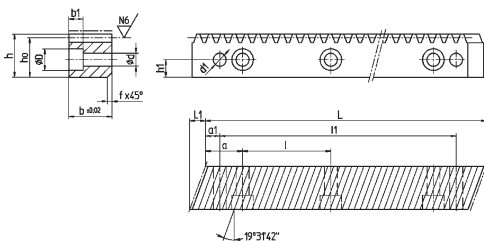

PART NUMBER	l	h ₁	d	D	b ₁	a ₁	l ₁	d ₁	F _p	m(kg)	PRICE EACH
HPC246012	125.00	8	7	11	7	31.7	436.6	5.7	0.029	1.3	£201.21
HPC246013	125.00	8	7	11	7	31.7	936.6	5.7	0.043	2.6	£288.26
HPC246022	125.00	8	7	11	7	31.7	436.6	5.7	0.025	2.1	£235.48
HPC246023	125.00	8	7	11	7	31.7	936.6	5.7	0.036	4.1	£333.89
HPC246032	125.00	9	7	11	7	31.7	436.6	5.7	0.027	2.0	£244.73
HPC246033	125.00	9	7	11	7	31.7	936.6	5.7	0.036	4.1	£345.42
HPC246042	125.00	9	10	15	9	35.0	430.0	7.7	0.028	3.0	£283.55
HPC246043	125.00	9	10	15	9	35.0	930.0	7.7	0.037	5.9	£404.70
HPC246052	125.00	12	10	15	9	33.3	433.0	7.7	0.030	5.4	£395.60
HPC246053	125.00	12	10	15	9	33.3	933.4	7.7	0.036	10.7	£562.55
HPC246062	125.00	12	14	20	13	37.5	425.0	11.7	0.028	6.5	£489.31
HPC246063	125.00	12	14	20	13	37.5	925.0	11.7	0.034	13.1	£699.78
HPC246072	125.00	16	18	26	17	37.5	425.0	15.7	0.031	10.0	£612.89
HPC246073	125.00	16	18	26	17	37.5	925.0	15.7	0.036	19.9	£873.54
HPC246082	120.00	25	22	33	21	120.0	240.0	19.7	0.029	22.0	£1134.20
HPC246083	120.00	25	22	33	21	120.0	720.0	19.7	0.033	44.0	£1618.96
HPC246092	125.00	32	33	48	32	125.0	250.0	19.7	0.029	34.0	£1506.90
HPC246093	125.00	32	33	48	32	125.0	750.0	19.7	0.032	68.0	£2151.80

F_p : Cumulative pitch error (mm)

m : Mass (kg)

