

Mechanical

Rotary Dampers

Bi - Directional

HPCFRTE2

Body: Polycarbonate plastic

Gear: Polyacetal Plastic

Fluid: Silicone

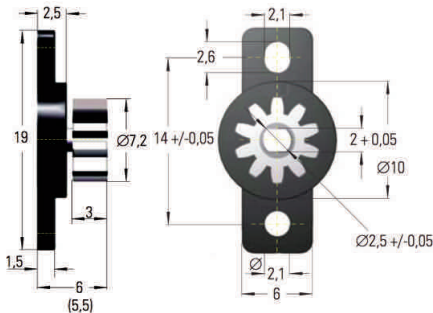

FRT-E2 (at 23°C)

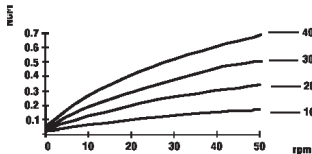

FRT-E2 (at 20 rpm)

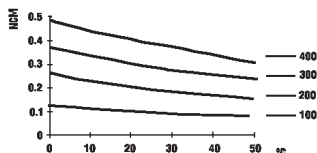

Material: Polycarbonate plastic
Temperature range: 0° C to 50° C

Tooth: Involute
Module: 0.6
Pressure angle: 20°
Number of teeth: 10
P.C.D.: 6 mm

DISCOUNTS

Quantity	List Price
1 - 24	
25 - 49	-15%
50 - 99	-25%
100 - 249	-35%
250 - 499	-50%
500 +	-60%

0.6 mod matching plastic racks available up to 1 metre.
Units are supplied with removable gear.

PART NUMBER	Damping Torque Ncm	Price Each 1-24
HPCFRTE2100G1	0.1 ± 0.05	£5.22
HPCFRTE2200G1	0.2 ± 0.07	£5.22
HPCFRTE2300G1	0.3 ± 0.08	£5.22
HPCFRTE2400G1	0.4 ± 0.10	£5.22