

Shafts & Bearings

Material

PBT High-grade Glass-filled Thermoplastic Polyester

Take Up



DISCOUNTS

	List Price
1 - 5	
6-19	-12%
20-39	-25%
40-59	-33%
60-99	-37%
100-199	-42%
200-499	-45%
500+	-48%

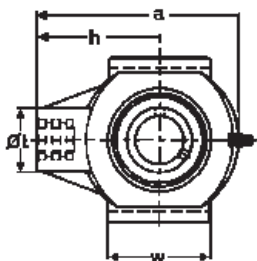

PART NUMBER	Bearing Bore Dia.		Dimensions (mm)				
	mm	inch	a	c	d	h	m
HPCTPL204S/S	20	3/4	99	27.5	12	64	76
HPCTPL205S/S	25	13/16, 7/8, 15/16, 1	99	27.5	12	64	76
HPCTPL206S/S	30	1 1/16, 1 1/8, 1 3/16, 1 1/4	125	34.5	12	76	89
HPCTPL207S/S	35	1 1/4, 1 5/16, 1 3/8, 1 7/16	125	34.5	12	76	89
HPCTPL208S/S	40	1 1/2, 1 9/16	140	34.5	16	85	102

PART NUMBER	Dimensions (mm)						Weight (kg)	PRICE EACH 1-5
	s	t	v	w	Bi	n		
HPCTPL204S/S	M16	36	88	47	31	12.7	0.16	£50.32
HPCTPL205S/S	M16	36	88	47	34	14.3	0.17	£55.29
HPCTPL206S/S	M16	40	102	63	38.1	15.9	0.22	£80.38
HPCTPL207S/S	M16	40	102	63	42.9	17.5	0.26	£94.13
HPCTPL208S/S	M16	40	114	80	49.2	19	0.38	£105.72

- Material: PBT
- Interchangeable with Cast Iron Housing
- Suitable for temperatures from -35°C to 102°C
- Stainless steel grease nipples as standard
- FDA approved
- Closed end cover as standard
- Solid base

Housing tear-out strength

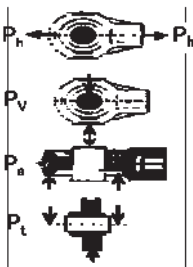

MODE OF LOAD	Breaking Point of Housing (N)				
	204	205	206	207	208
P_h	14800	15500	15800	16500	17300
P_v	3930	4530	5100	6500	7800
P_a	8500	10350	10900	11300	12150
P_t	40770	45300	46100	44100	42800