

Material

Steel & Stainless Steel

Couplings**Double Universal Joints****DISCOUNTS**

1 - 9	List Price
10-24	-2%
25-49	-4%
50 +	-6%

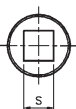
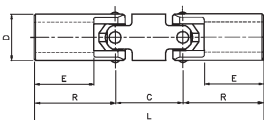

* All bores supplied solid (unbored as standard).

PART NUMBER													PRICE EACH 1-5	
Steel	Stainless	D	L	E Min	R	C	* B	'B' Max				SBT	Steel	Stainless
								MB	WK	S	H			
HPCMF16	HPCSMF16	16	83	16	28	25	8	10	8			45	£124.39	£247.25
HPCMF20	HPCSMF20	20	92	18	31	30	10	13	11	10	10	88	£127.92	£322.74
HPCMF25	HPCSMF25	25	122	25	43	36	12	16	14	12	12	180	£145.60	£339.38
HPCMF32	HPCSMF32	32	143	27.5	47.5	47	16	22	18	16	16	405	£196.65	£403.58
HPCMF40	HPCSMF40	40	164	30	54	56	20	25	22	19	19	860	£219.21	£531.98
HPCMF45	HPCSMF45	45	190	33.5	63.5	63	20	30	25	22	22	1250	£265.93	£660.37
HPCMF50	HPCSMF50	50	210	41	70	70	25	35	30	25	25	1730	£328.81	£871.40
HPCMF63	HPCSMF63	63	262	52	89	84	32	45	35	32	32	3400	£439.41	£1146.75

B : Standard round bore available to order,
if required please add an additional £15.00 per end

MB : Max round bore available

WK : Max round bore available with keyway, please contact sales for a quote

S : Max square bore available, please contact sales for a quote

H : Max hexagon bore available, please contact sales for a quote

SBT : Static Breaking Torque (Nm)

