

Materials **BUDGET Worms & Wheels**

STD : Phosphor Bronze PB2
and Steel 080 M40 (En8)

20° P.A.

1 MOD, 3.142mm Pitch



**LEAD
ANGLE
RIGHT
HAND
STANDARD**



Note: When ordering the wormwheel, the number of starts on the mating worm must be specified.

Worm STEEL 080 M40 (En8)

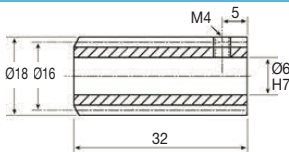

UNHARDENED

PART NUMBER	No. of Starts	Lead Angle	PRICE EACH			
			1+	5+	10+	25+
EW1-1	1	3°35'	£9.99	£9.58	£9.38	£8.99
EW1-2	2	7°11'	£10.19	£9.78	£9.57	£9.17

Used to produce high reduction ratios in low loading applications. The worm is manufactured from BS 80 M40 (En8) Steel and the Wormwheels from PB2 (Phosphor Bronze). The worm comes complete with grub screw fixing.

Wheel PHOSPHOR BRONZE - PB2

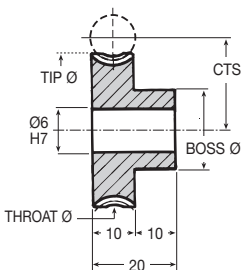

UNHARDENED

PART NUMBER	Teeth	Ratio Reduction	PCD mm	CTS mm	Throat Ø mm
EM1-20/1	20	1/20	20	18	22
EM1-20/2	20	1/10	20	18	22
EM1-30/1	30	1/30	30	23	32
EM1-30/2	30	1/15	30	23	32
EM1-40/1	40	1/40	40	28	42
EM1-50/1	50	1/50	50	33	52

PART NUMBER	Tip Ø mm	Boss Ø mm	PRICE EACH			
			1-4	5-9	10-24	25+
EM1-20/1	23	16	£12.48	£11.85	£11.61	£11.23
EM1-20/2	23	16	£12.48	£11.85	£11.61	£11.23
EM1-30/1	33	20	£18.66	£17.72	£17.35	£16.79
EM1-30/2	33	20	£18.66	£17.72	£17.35	£16.79
EM1-40/1	43	26	£26.32	£25.01	£24.48	£23.69
EM1-50/1	53	30	£33.85	£32.15	£31.47	£30.46

BUDGET Worms & Wheels EW EM

