

Anti-backlash Wormwheels Materials

1.25 MOD

STD : Phosphor Bronze PB2
SPECIAL TEETH : between 45 - 120

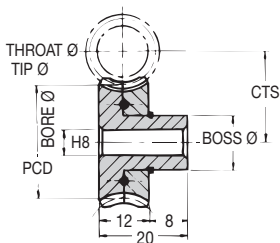

20° Pressure Angle

TORQUE CHECK	50 TEETH x 1000 R.P.M. INPUT
variations at back	with std worm
TORQUE Nm	1.14
K.W.	0.024

DISCOUNTS

1 - 5	List Price
6 - 19	- 12%
20 - 39	- 25%
40 - 59	- 33%
60 - 99	- 37%
100 - 200	- 42%

Anti-backlash Wormwheels

MOD 1.25

PART NUMBER	TEETH	PCD (mm)	CTS (mm)	THROAT Ø (mm)	TIP Ø (mm)	BOSS Ø (mm)	BORE Ø (mm)	PRICE EACH 1-5
ABM1.25-45	45	56.25	36.13	58.75	60.00	25	10	£95.59
ABM1.25-48	48	60.00	38.00	62.50	63.75	25	10	£100.31
ABM1.25-50	50	62.50	39.25	65.00	66.25	25	10	£107.00
ABM1.25-52	52	65.00	40.50	67.50	68.75	32	12	£109.79
ABM1.25-54	54	67.50	41.75	70.00	71.25	32	12	£114.53
ABM1.25-55	55	68.75	42.38	71.25	72.50	32	12	£119.29
ABM1.25-58	58	72.50	44.25	75.00	76.25	32	12	£124.01
ABM1.25-60	60	75.00	45.50	77.50	78.75	32	12	£128.84
ABM1.25-62	62	77.50	46.75	80.00	81.25	32	12	£133.73
ABM1.25-64	64	80.00	48.00	82.50	83.75	32	12	£138.61
ABM1.25-65	65	81.25	48.63	83.75	85.00	32	12	£143.53
ABM1.25-68	68	85.00	50.50	87.50	88.75	32	12	£151.20
ABM1.25-70	70	87.50	51.75	90.00	91.25	32	12	£153.38
ABM1.25-72	72	90.00	53.00	92.50	93.75	32	12	£158.15
ABM1.25-74	74	92.50	54.25	95.00	96.25	32	12	£162.96
ABM1.25-75	75	93.75	54.88	96.25	97.50	32	12	£167.72
ABM1.25-78	78	97.50	56.75	100.00	101.25	32	12	£172.50
ABM1.25-80	80	100.00	58.00	102.50	103.75	32	12	£177.29
ABM1.25-82	82	102.50	59.25	105.00	106.25	32	12	£196.75
ABM1.25-85	85	106.25	61.13	108.75	110.00	32	12	£216.14
ABM1.25-88	88	110.00	63.00	112.50	113.75	32	12	£235.56
ABM1.25-90	90	112.50	64.25	115.00	116.25	32	12	£254.99
ABM1.25-95	95	118.75	67.38	121.25	122.50	50	12	£274.47
ABM1.25-98	98	122.50	69.25	125.00	126.25	50	12	£293.90
ABM1.25-100	100	125.00	70.50	127.50	128.75	50	12	£313.37
ABM1.25-110	110	137.50	76.75	140.00	141.25	50	12	£364.26
ABM1.25-120	120	150.00	83.00	152.50	153.75	50	12	£415.13

16.6



Unit 14, Foxwood Ind. Park, Foxwood Rd. Chesterfield, Derbyshire S41 9RN
Telephone +44(0)1246 268080 Fax +44(0)1246 260003