

Output Torque Range
21.5Nm to 83Nm

Ratio
2:1 - 7:1

Gearboxes

HPCFF30

Offset Spur Gear Reducers

WEIGHT	5.5 Kg
BACKLASH (approx.)	1° approx
HOURS LIFE	12000 hr
MAX INPUT SPEED	2000 rpm
MATERIAL:	
CASE MAT'L	Aluminium HE30TF
GEAR MAT'L	817M40 (EN24) & 655M13 Case/HD (EN36)
GREASED FOR LIFE	Shell Gadus

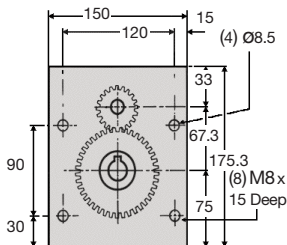
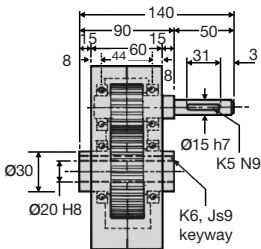

N.m.	RPM Input	Reduction ratio					
		2:1	3:1	4:1	5:1	6:1	7:1
Output Torque	2000	33.2	29.1	25.2	24.3	25.3	23.0
	1000	39.1	34.4	29.8	28.7	30.0	27.1
	500	45.2	39.7	34.4	33.1	34.5	31.3
	200	54.3	47.6	41.3	39.7	41.4	37.5
	100	60.4	52.9	45.9	44.2	46.0	41.8
	50	69.0	60.8	53.0	50.8	53.0	48.0
	10	83.0	72.7	63.0	60.7	63.3	57.5

DISCOUNTS

Quantity	List Price
1 - 5	
6 - 19	-5%
20 - 49	-10%
50 - 99	-15%
100 +	-20%

PART NUMBER	Ratio	% Effi. @ 1000 rpm	Max Input Speed	Max Output Speed	Nm Output @ 1000 rpm	PRICE EACH 1-5
HPCFF30-2	2:1	93	2000	1000	39.10	£312.96
HPCFF30-3	3:1	93	2000	666	34.40	£312.96
HPCFF30-4	4:1	93	2000	500	29.80	£312.96
HPCFF30-5	5:1	93	2000	400	28.70	£312.96
HPCFF30-6	6:1	93	2000	333	27.30	£312.96
HPCFF30-7	7:1	93	2000	285	25.10	£312.96
HPCFF30-XH	Hardened Gears 2:1 to 7:1 multiply torque figures by 2					£487.69

Other Info.

Testing in your application is necessary.

You will need to assess duty, cycles and confirm gearbox suitability with your own calculations.

Torque figures are to be used for guidance only.

Unit 14, Foxwood Industrial Park, Foxwood Rd. Chesterfield, Derbyshire S41 9RN

Telephone +44(0)1246 268080 Fax +44(0)1246 260003



1.55

Gearboxes

OFFSET SPUR GEAR REDUCERS

HPCFF30