

**Output Torque Range**  
3Nm to 10.3Nm

**Ratio**  
1:1 - 2:1

**Gearboxes**

**HPCBLHT40**

**Heavy Duty, Hardened Bevel Tee**

<b>WEIGHT</b>	1.0 Kg
<b>BACKLASH (approx.)</b>	1° approx
<b>HOURS LIFE</b>	12000 hr
<b>MAX INPUT SPEED</b>	4000 rpm
<b>MATERIAL:</b>	
<b>CASE MAT'L</b>	Aluminium HE30TF
<b>BEVEL MAT'L</b>	655M13 Case/HD (EN36)
<b>GREASED FOR LIFE</b>	Shell Alvania

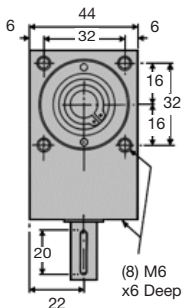
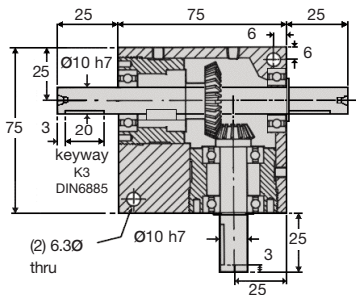

N.m.	RPM Input	Reduction ratio	
		1:1	2:1
Output Torque	3000	4.0	3.0
	2000	4.4	3.4
	1000	5.1	4.0
	500	5.8	4.6
	100	7.6	6.0
	50	8.5	6.3
	10	10.3	8.0

DISCOUNTS	
1 - 5	List Price
6 - 19	-5%
20 - 49	-10%
50 - 99	-15%
100 +	-20%

PART NUMBER	Ratio	% Efficiency	Max Input Speed	Max Output Speed	Module	PRICE EACH 1-5
HPCBLHT40-1	1:1	88	4000	4000	1	£248.14
HPCBLHT40-2	2:1	88	4000	2000	1	£248.14

**Other Info.**

Testing in your application is necessary.

You will need to assess duty, cycles and confirm gearbox suitability with your own calculations. Torque figures are to be used for guidance only.

**Bevel Gearboxes**

HEAVY DUTY, HARDENED BEVEL TEE

HPCBLHT40

